

**Rear belt, 4D****To remove**

1. Raise the rear seat's seat cushion.
2. Remove the lower belt anchorage point (A)

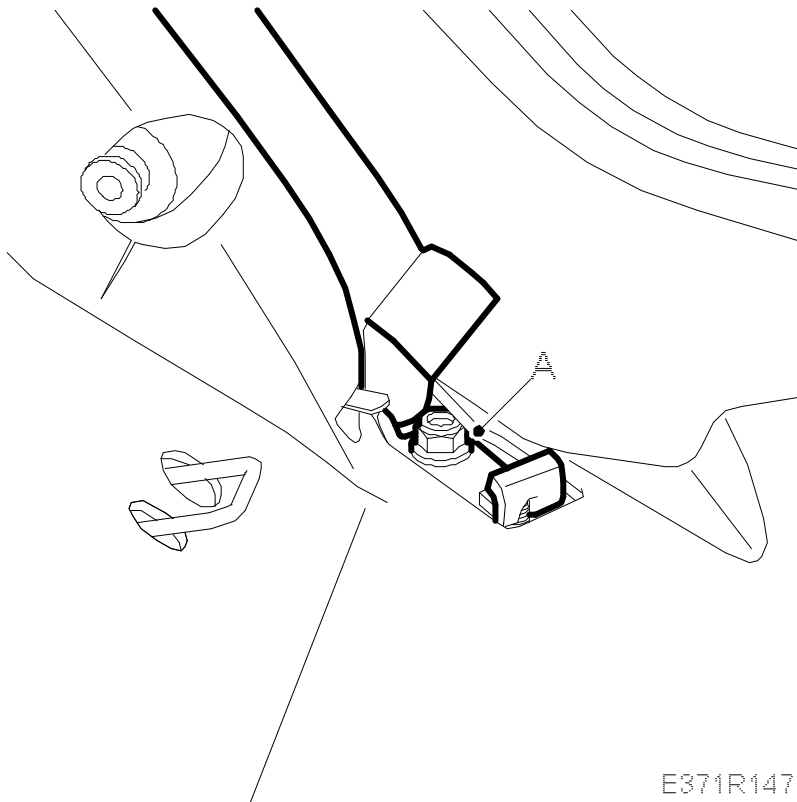

3. Lower the backrest.
- 4.

Remove the rear seat head restraint (A)

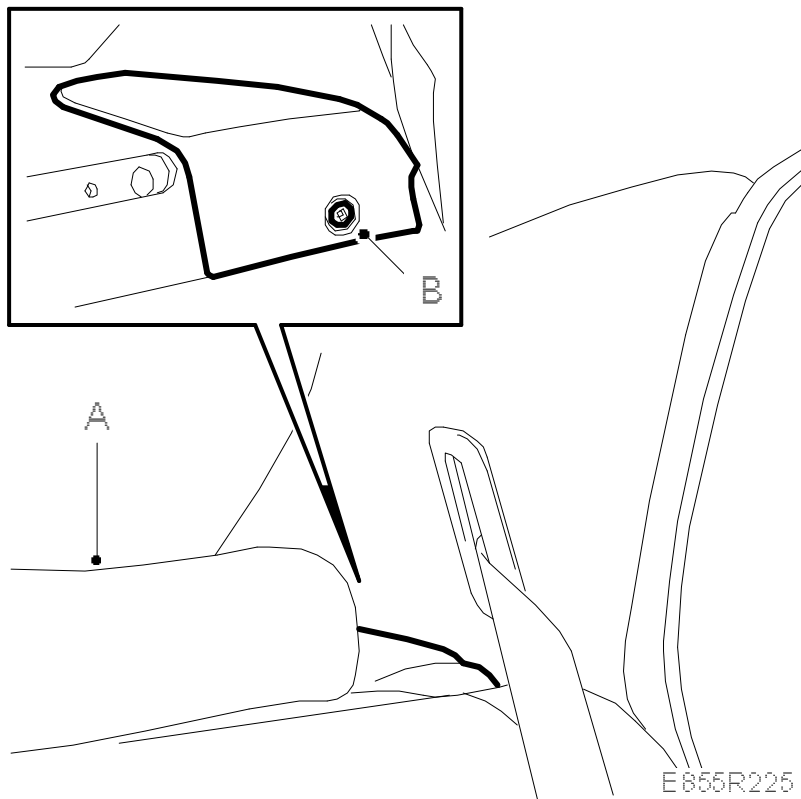

5. Remove the speaker grille (B) (fastened with clips) in the parcel shelf.

6.

Remove the C-pillar trim (C) (fastened with clips).

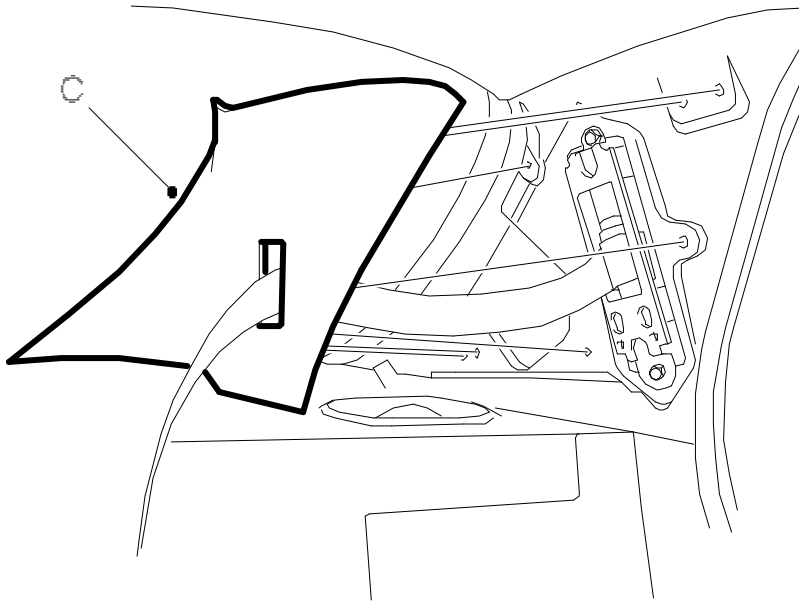

E855R226

7. Detach the seatbelt guide from the C-pillar trim (A).

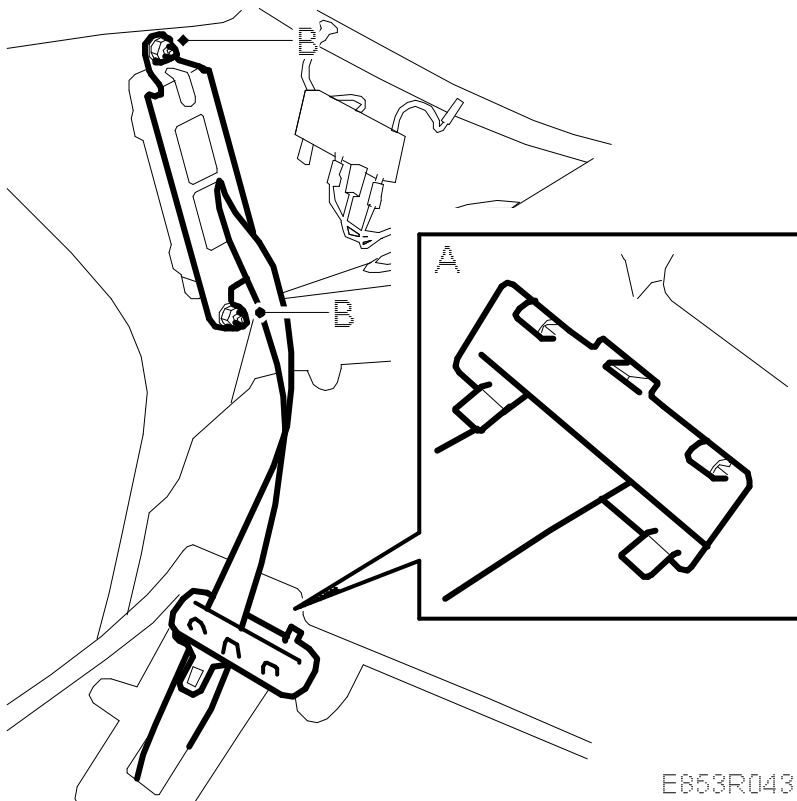

E853R043

8. Draw the belt through the C-pillar trim.
9. Remove the upper belt anchorage point from the C-pillar (B).
10. Lift the inertia reel away from the body.

**To fit**

1. Fit the belt onto the C-pillar's studs.

**Note**

Use new nuts.

2. Fit the upper belt anchorage point (B)

**Tightening torque: 45 Nm (33 lbf ft)**

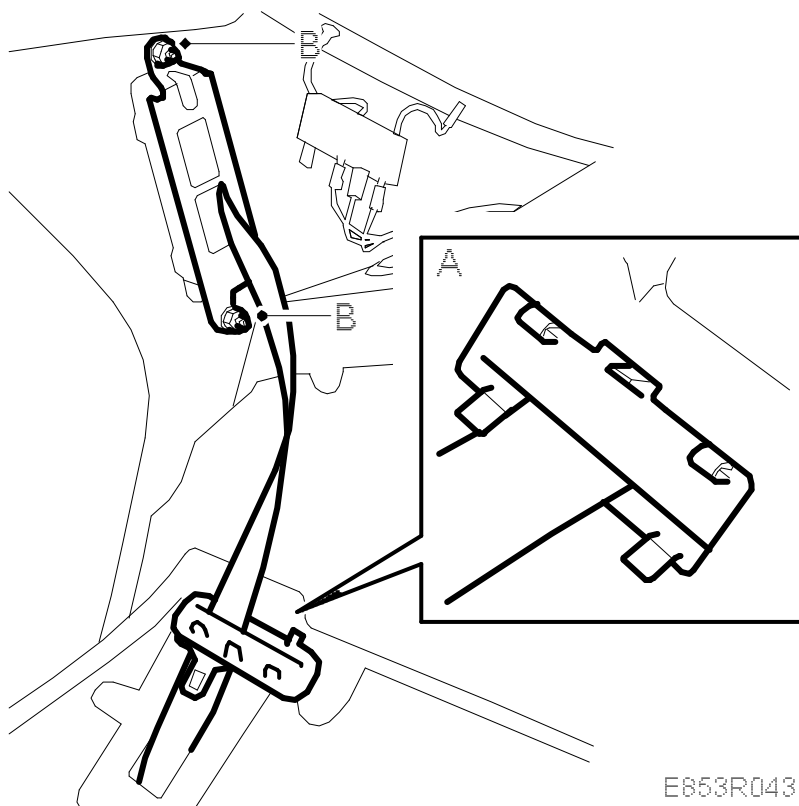

3. Thread the belt through the C-pillar and fit the seatbelt guide (A).
- 4.

Fit the C-pillar trim (C) (fastened with clips). The C-pillar trim has 2 guide pins.

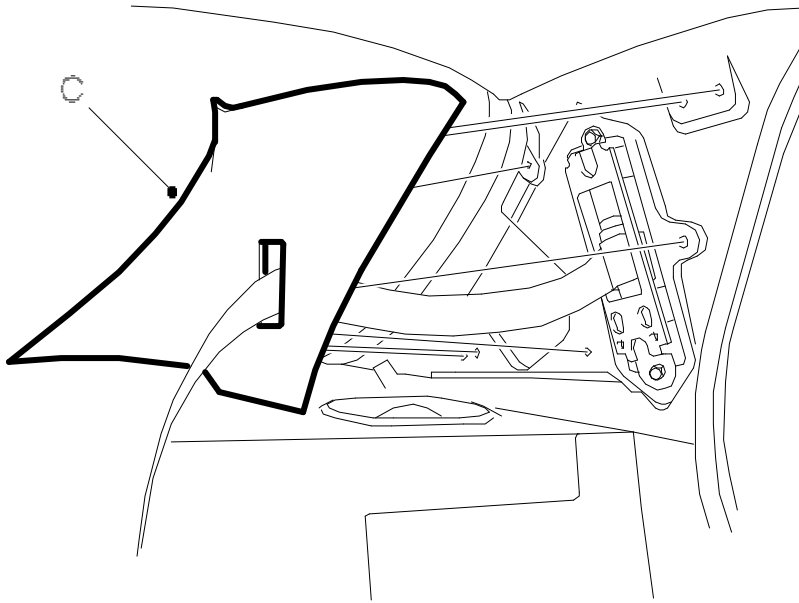

E855R226

5. Fit the speaker grille (B) (fastened with clips) in the parcel shelf.

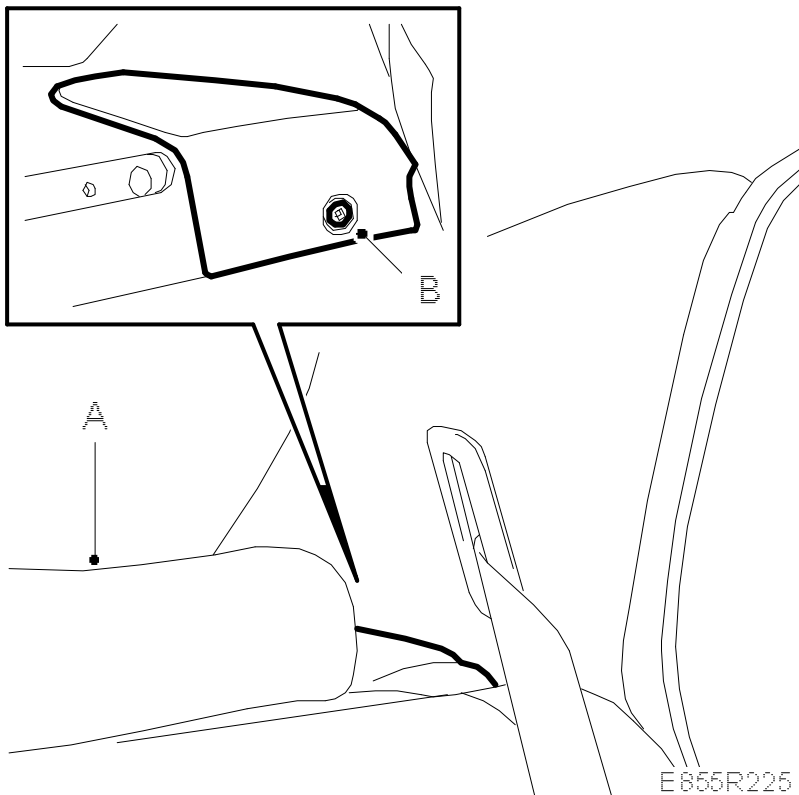

E855R225

6. Screw in the head restraint for the rear seat (A).
7. Check that the door weatherstrip fits correctly.
8. Raise the backrest.

**Note**

Use new nuts.

9. Fit the lower belt anchorage point (A).

**Tightening torque: 45 Nm (33 lbf ft)**

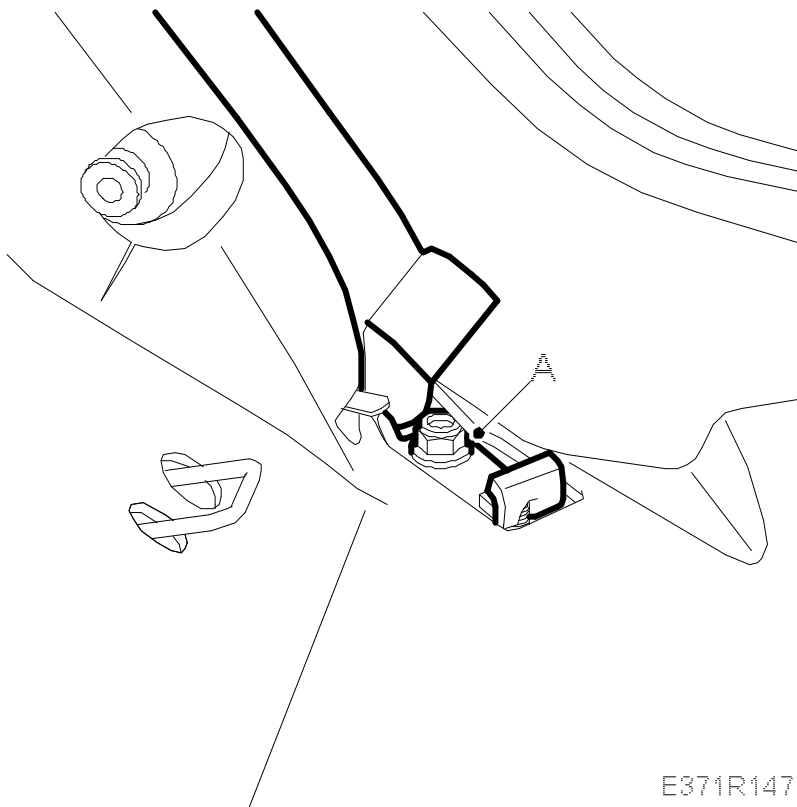

10. Fold back the seat cushion.

---

**Important**

Make sure that the belt runs properly.

---