

Input shaft speed sensor**To remove**

1. Remove the battery cover, battery and battery tray.
2. Disconnect the battery cable.
- 3.

Clean the area round the sensor. Remove the sensor's retaining bolt.

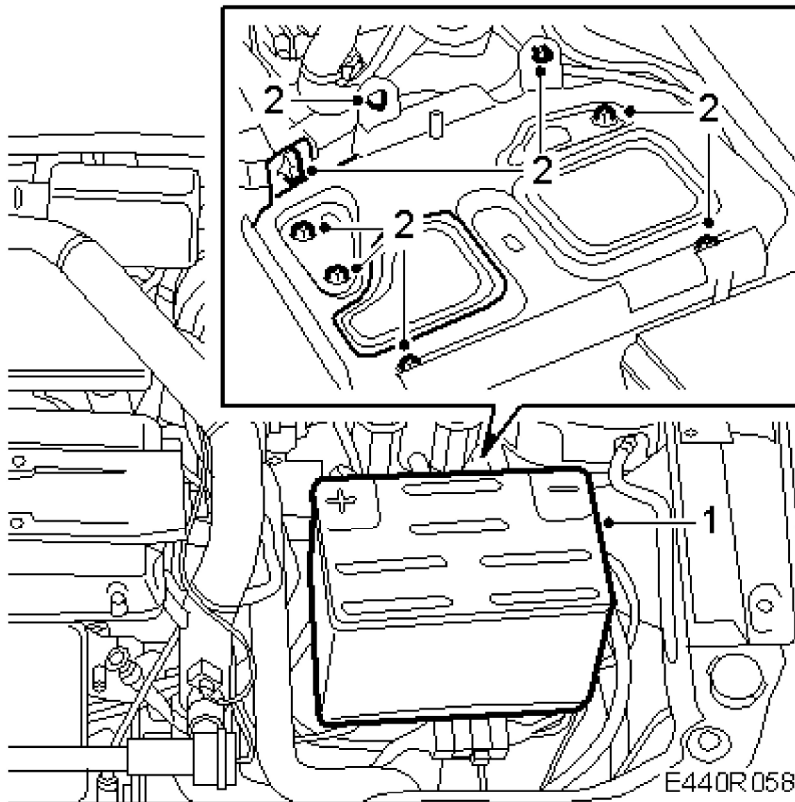
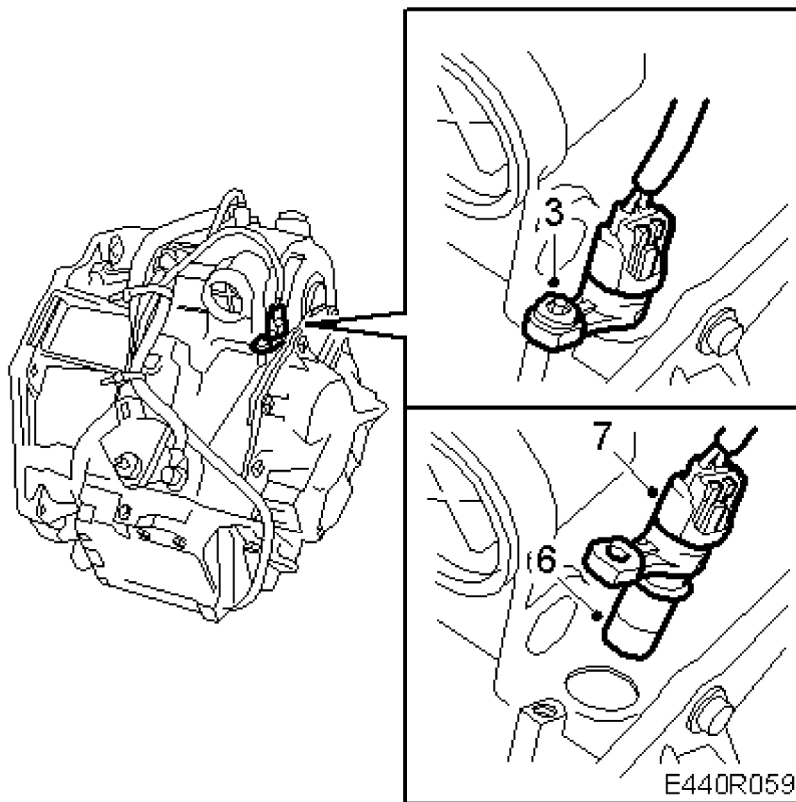

4. Raise the car.
5. Remove the left-hand front wheel.
6. Gently work the sensor out of its location.
7. Unplug the connector.

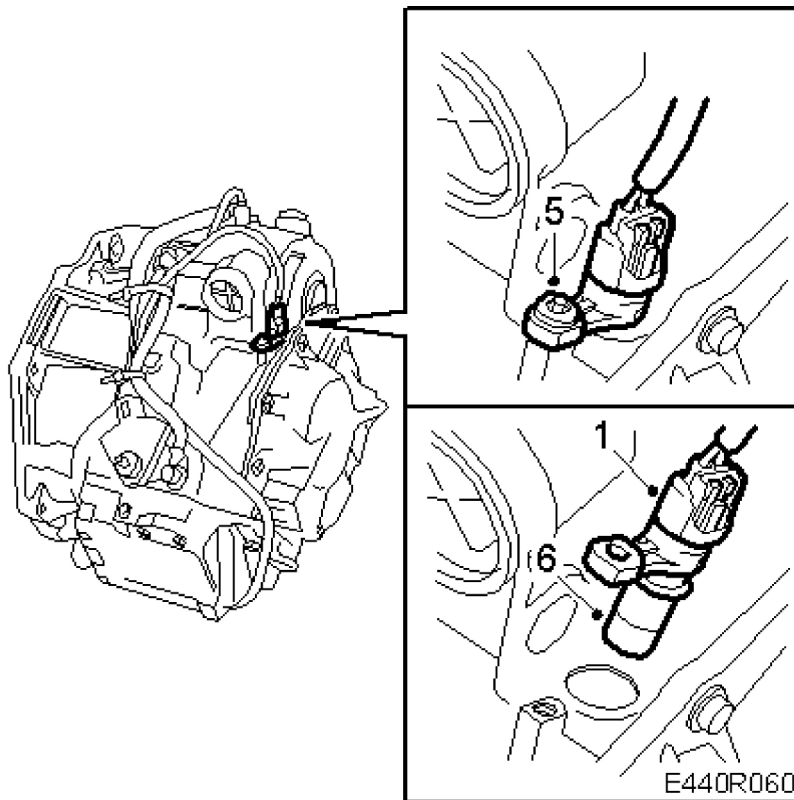

1. Connect the sensor.
2. Fit the sensor in place.
3. Fit the front wheel.

Tightening torque: 120 Nm (89 lbf ft)

4. Lower the car to the floor.
5. Tighten the sensor's retaining bolt.

Tightening torque: 6 Nm (4.5 lbf ft)

- 6.

Refit the battery tray, battery and battery cover.

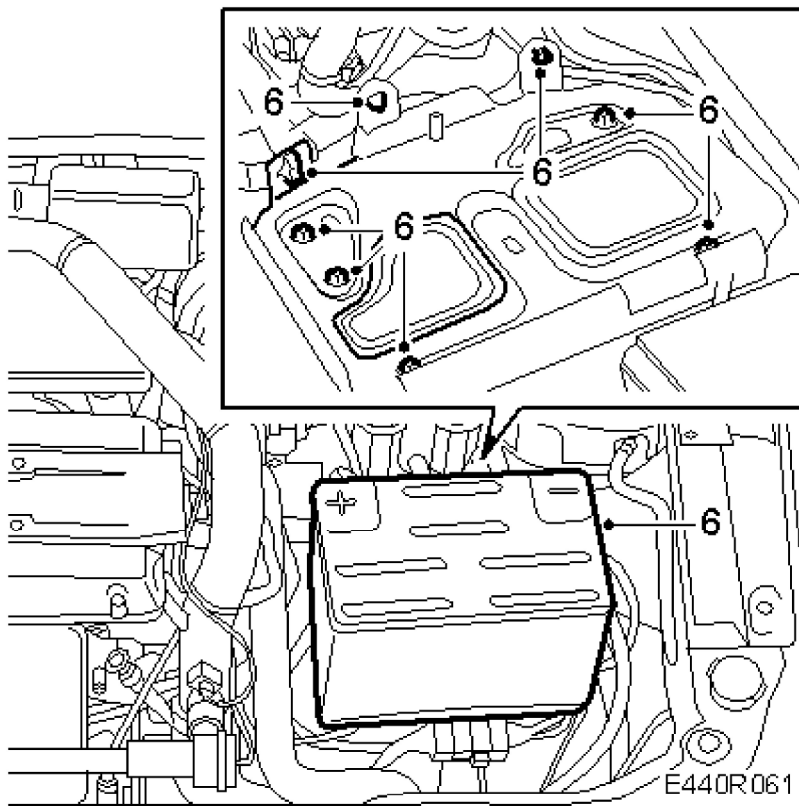

7. Set the right time on the clock.